

Product End of Life Instructions

MCB E-Frame





End of Life Instructions

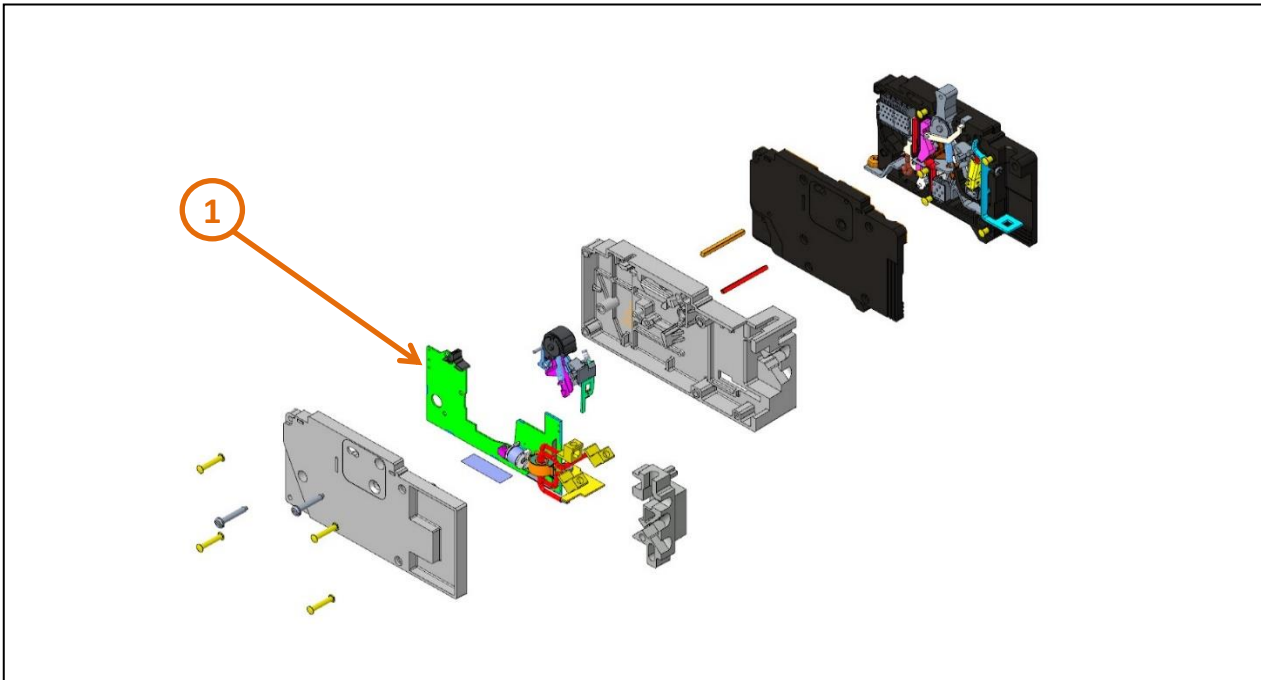

| Recommendation | Number on drawing | Component / Material | Weight (in g) | Comment |
|------------------|-------------------|--|---------------|-------------------------------|
| To be depolluted | 1 | Electronic Board (Communication) > 10cm ² | 79.13 | Including all soldering parts |



Product description

| | |
|-----------------------------------|--|
| Manufacturer identification | Schneider Electric Industries SAS |
| Brand name | Square D |
| Product function | The main purpose of the MCB E-Frame is to ensure protection of low voltage electrical installations. |
| Product reference | EDB14020EPD |
| Total representative product mass | 910 g |
| Representative product dimensions | 169mm x 50mm x 103mm |
| Accessories | No |
| Date of information release | 11/2021 |



Additional information

| | | |
|--|--|---|
| Legal information | This product family is in the scope of European Union directive 2012/19/EU on Waste Electrical and Electronic Equipment (WEEE). The product family must be disposed according to the legislation of the country. This document is intended for use by end of life recyclers or treatment facilities. It provides the basic information to assure an appropriate end of life treatment for the components and materials of the product. | |
| In case of special transportation: transportation method | No | |
| Recyclability potential | 31% | Based on "ECO'DEEE recyclability and recoverability calculation method" (version V1, 20 Sep. 2008 presented to the French Agency for Environment and Energy Management: ADEME). |

Schneider Electric Industries SAS
Country Customer Care Center
<http://www.schneider-electric.com/contact>
35, rue Joseph Monier
CS 30323
F- 92506 Rueil Malmaison Cedex
RCS Nanterre 954 503 439
Capital social 896 313 776 €
www.schneider-electric.com
ENVEOLI1405001_V2

Published by Schneider Electric
© 2019 - Schneider Electric – All rights reserved

11/2021